

TLGA February Board Meeting Agenda
February 9, 2026 6pm
East Olympia Fire House

- I. Meeting called to order:
 - A. Roll call:
 - Community members:

- II. Past business
 - A. Approval of past minutes:
 - B. Update of previous business
 - 1. Park signs update (Ide)
 - 2. Tempo Lake Drive community signage

- III. Financial update (Sanches/Brown)
 - A. Statements coming
 - B. Current financial status

- IV. Water/Parks update (Bircher/Ide/Yenney)

- V. New business
 - A. Lynn as Secretary/Treasurer (Article 4, Section 1 re:combined responsibilities)

- VI. Member items

- VII. Executive Committee (if needed)

- VIII. Motion to Adjourn:

Next meeting March 9, 2026 6pm

Current Park Signage

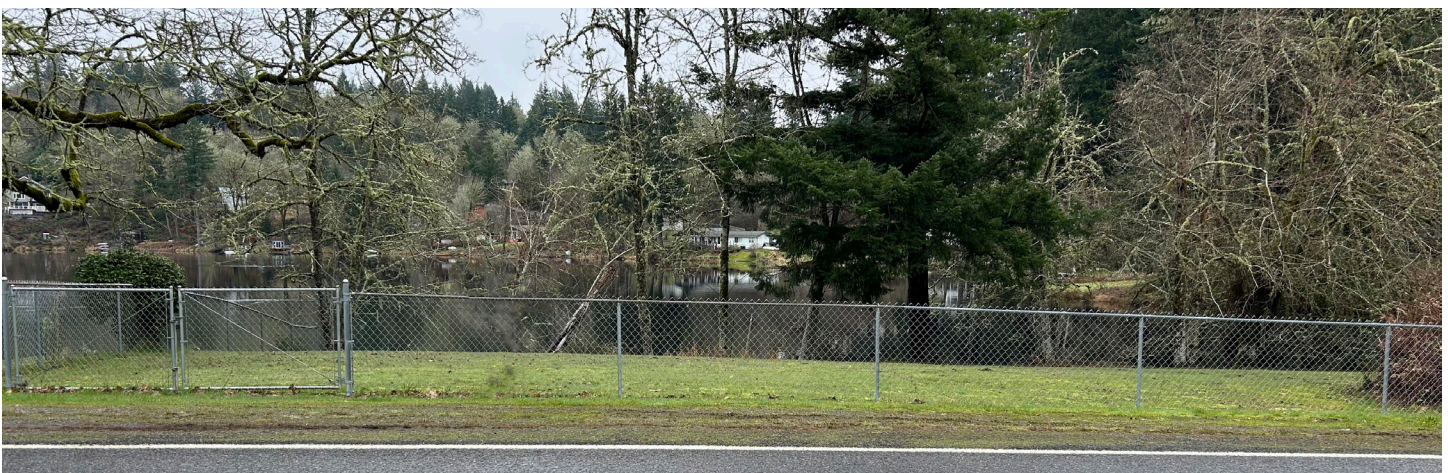

Current Park Signage



PRIVATE LAKE
CLOSED TO NON-RESIDENTS
ALL GUESTS MUST BE ACCOMPANIED BY A RESIDENT
PARK HOURS - DAWN TO 9:00 PM

1. FISHING AND PARK USE BY NON-RESIDENTS IS CONSIDERED THEFT AND TRESPASSING. VIOLATORS WILL BE PROSECUTED
2. RESIDENTS BOATS ONLY
3. NO LIFEGUARD - SWIM AT YOUR OWN RISK
4. CHILDREN UNDER 12 MUST BE ACCOMPANIED BY AN ADULT
5. NO ALCOHOL, LOUD MUSIC, OR OFFENSIVE LANGUAGE
6. BUILD FIRES IN DESIGNATED AREAS ONLY
7. NO ANIMALS, FIREWORKS, OR MOTORCYCLES IN ANY PARK AREAS
8. REMOVE YOUR TRASH FROM PARK



PRIVATE LAKE
CLOSED TO NON-RESIDENTS
ALL GUESTS MUST BE ACCOMPANIED BY A RESIDENT
PARK HOURS - DAWN TO 9:00 PM

1. FISHING AND PARK USE BY NON-RESIDENTS IS CONSIDERED THEFT AND TRESPASSING. VIOLATORS WILL BE PROSECUTED
2. RESIDENTS BOATS ONLY
3. NO LIFEGUARD - SWIM AT YOUR OWN RISK
4. CHILDREN UNDER 12 MUST BE ACCOMPANIED BY AN ADULT
5. NO ALCOHOL, LOUD MUSIC, OR OFFENSIVE LANGUAGE
6. BUILD FIRES IN DESIGNATED AREAS ONLY
7. NO ANIMALS, FIREWORKS, OR MOTORCYCLES IN ANY PARK AREAS
8. REMOVE YOUR TRASH FROM PARK

PRIVATE LAKE
CLOSED TO NON-RESIDENTS
ALL GUESTS MUST BE ACCOMPANIED BY A RESIDENT
PARK HOURS - DAWN TO 9:00 PM

1. FISHING AND PARK USE BY NON-RESIDENTS IS CONSIDERED THEFT AND TRESPASSING. VIOLATORS WILL BE PROSECUTED
2. RESIDENTS BOATS ONLY
3. NO LIFEGUARD - SWIM AT YOUR OWN RISK
4. CHILDREN UNDER 12 MUST BE ACCOMPANIED BY AN ADULT
5. NO ALCOHOL, LOUD MUSIC, OR OFFENSIVE LANGUAGE
6. BUILD FIRES IN DESIGNATED AREAS ONLY
7. NO ANIMALS, FIREWORKS, OR MOTORCYCLES IN ANY PARK AREAS
8. REMOVE YOUR TRASH FROM PARK

PRIVATE LAKE
CLOSED TO NON-RESIDENTS
ALL GUESTS MUST BE ACCOMPANIED BY A RESIDENT
PARK HOURS - DAWN TO 9:00 PM

1. FISHING AND PARK USE BY NON-RESIDENTS IS CONSIDERED THEFT AND TRESPASSING. VIOLATORS WILL BE PROSECUTED
2. RESIDENTS BOATS ONLY
3. NO LIFEGUARD - SWIM AT YOUR OWN RISK
4. CHILDREN UNDER 12 MUST BE ACCOMPANIED BY AN ADULT
5. NO ALCOHOL, LOUD MUSIC, OR OFFENSIVE LANGUAGE
6. BUILD FIRES IN DESIGNATED AREAS ONLY
7. NO ANIMALS, FIREWORKS, OR MOTORCYCLES IN ANY PARK AREAS
8. REMOVE YOUR TRASH FROM PARK